



WALTZ

TECHNISCHES BLATT
SCHEDA TECNICA
DATA SHEET
FICHE TECHNIQUE

WALTZ

DESIGN GAMFRATESI, 2016



Modular aufgebaute Wandgarderobe aus Eschenbugholz.

Appendiabiti modulare da parete in frassino curvato.

Modular wall-mounted bent ash-wood coat rack.

Porte-manteaux modulable mural en frêne cintré.

Perchero modular de pared en fresno curvado.



CHWALZLGN

Dimensions mm.

height 540 | width 930 | depth 70

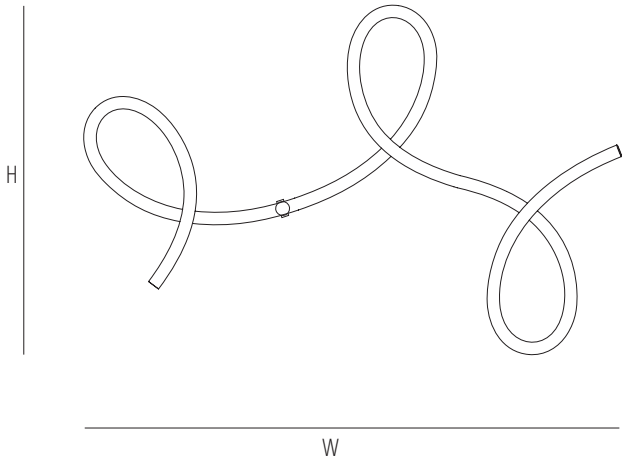

	H	W	D	SH	AH
mm	540	930	70		
inch	21,2	36,6	2,7		

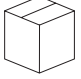

1

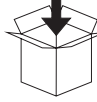

max. 1



0,04

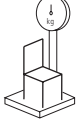

2

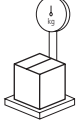

3

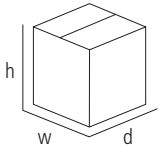

mm - inch
h 550 - 21,6
w 940 - 37
d 80 - 3,1

Verfuegbare Ausfuehrungen
Finiture disponibili
Available finishes
Finitions disponibles

SOLID WOOD / ESSENZE NATURALI



B07 ASH
B07 FRASSINO

CLASSIC LACQUER / LACCATO CLASSICO

*Ash wood is open-pore painted
* L'essenza frassino è verniciata a poro aperto



C01 - RAL 9005 BLACK

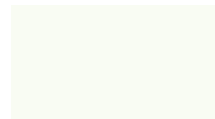

C02 - RAL 9010 PURE WHITE

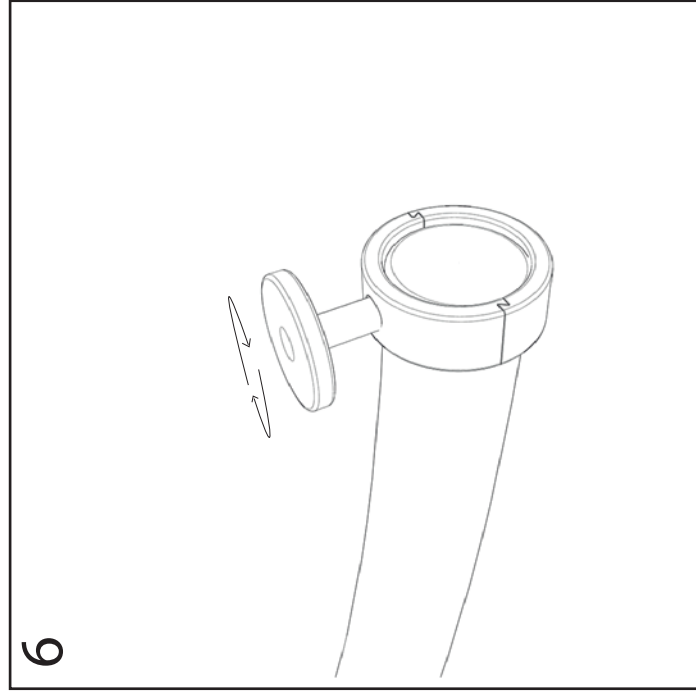
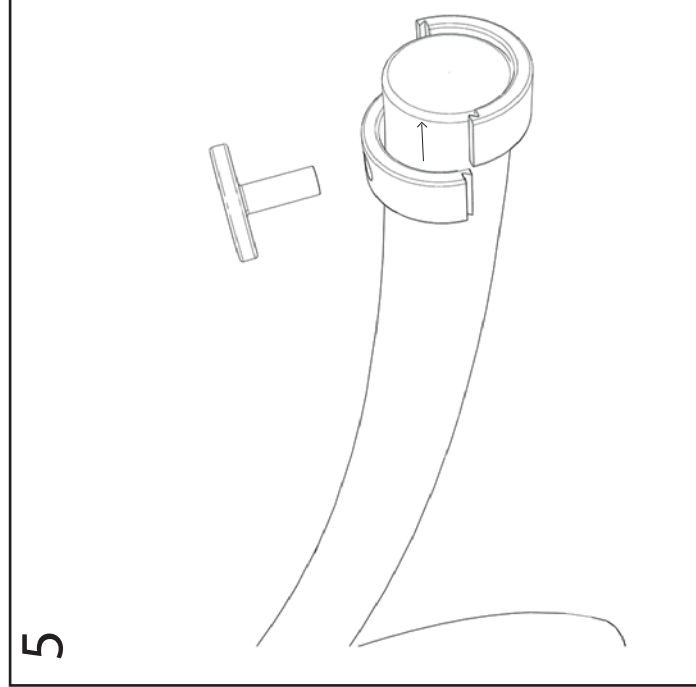
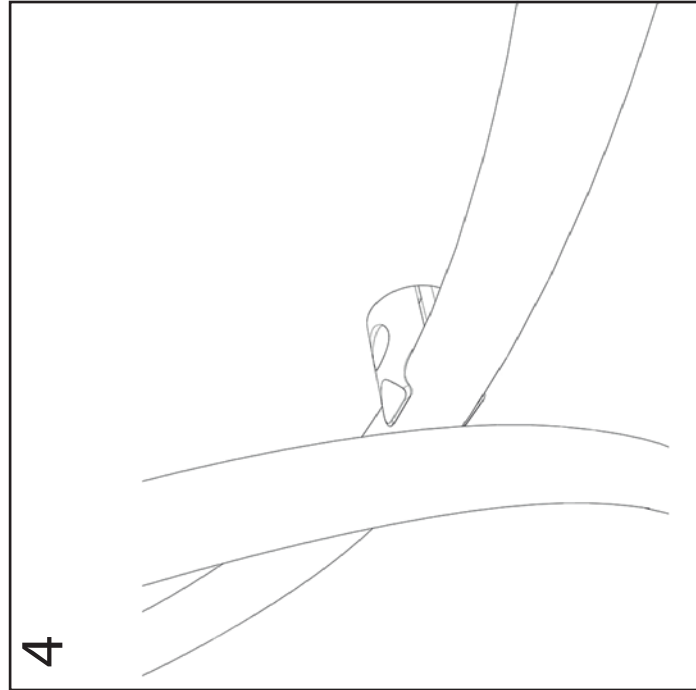
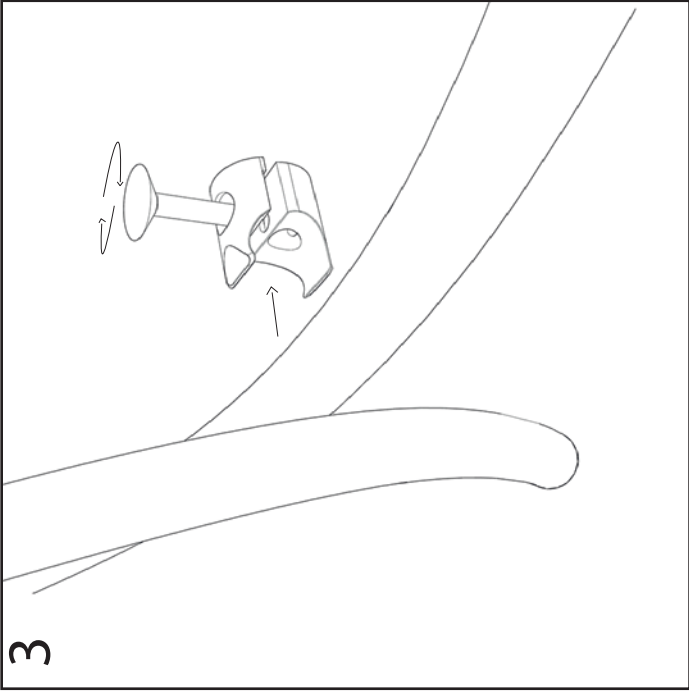
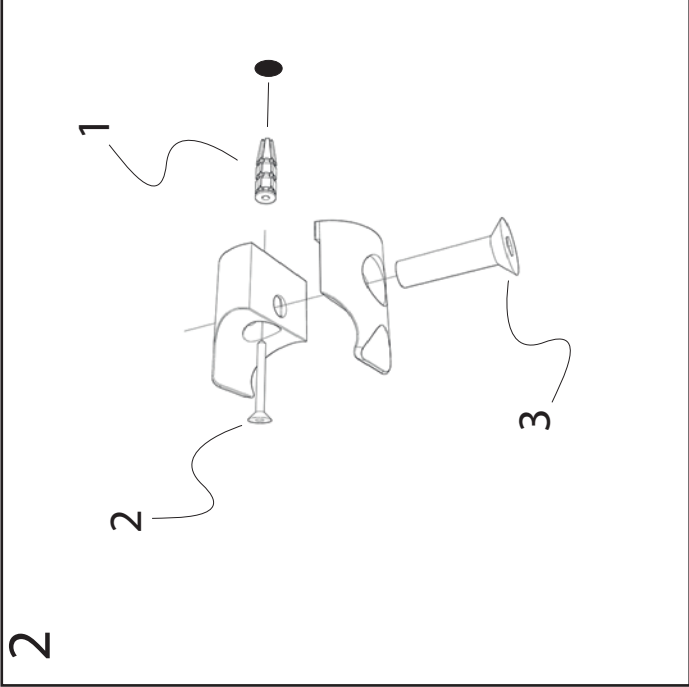
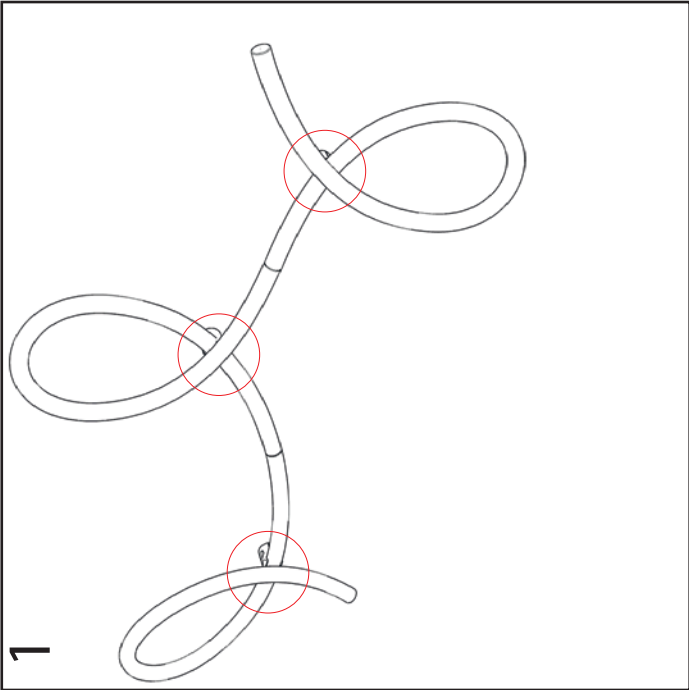

Gebrüder Thonet Vienna GmbH
Prinz Eugen Straße 42
1040 Wien (AT)

www.gebruederthonetvienna.com

Offices of the trademarks' licensee
Production Furniture International S.p.A.
Via Foggia, 23/H
10152 Torino (TO) Italy

Phone: 0039 011 0133330 - info@gebruederthonetvienna.com